

## LOW RANGE PRESSURE TRANSMITTER

### Special Features:

- Ranges As Low As 5 mbar
- Available for Liquids and Gases
- Crevice Free Stainless Steel Construction
- No Seals or O-Rings
- Silicon Semiconductor Strain Gauge Technology
- Surge Protection, Reverse Voltage Protection to 36V DC



### Applications:

LR1200 Low Range Pressure Transmitters with Compact Design are used for various applications in Aviation Industry, Pharmaceuticals, Refrigeration and HVAC Controls, Process Control, Motor Fuel Control, Water Pressure Monitoring and High end industrial machinery.

### Performance Specifications:

Pressure Range	: 5 mBar ~ 1000 mBar
Accuracy	: ±0.25%
Operating Temp.	: - 40°C to 125°C
Compensated Temp.	: - 20°C to 85°C
Proof Pressre	: 2X
Burst Pressure	: 5X
Input Voltage	: 12 - 36 VDC
Output	: 4-20 mA , 0-10V , 0-5V, 0.5-4.5V Ratiometric, 1-5V

---

Wetted Parts	: 17-4 PH SS
Diaphragm	: AISI 316L SS
Case	: AISI 304 SS
Connector	: Nylon 6/6
Media Compatibility	: All Materials compatible with Stainless Steel
Protection	: IP 65; IP68 (Cable Version)

---

		<b>2 Wire</b>	<b>3 Wire</b>	<b>3 Wire</b>
Output	:-	4 - 20mA	0.5 - 4.5V	0 - 10V
Excitation (V)	:	12 - 36V	4.75 - 5.25V	15 - 30V

### Standard Ranges:

RANGE (MBAR)	RANGE (MBAR)
0/5	0/10
0/15	0/20
0/25	0/50
0/75	0/100
0/150	0/200
0/250	0/300
0/350	0/400
0/500	0/600
0/750	0/1000

\* Non Standard Ranges And Various Engineering Units Available On Request

## LOW RANGE PRESSURE TRANSMITTER

### ⚙️ Dimensions:

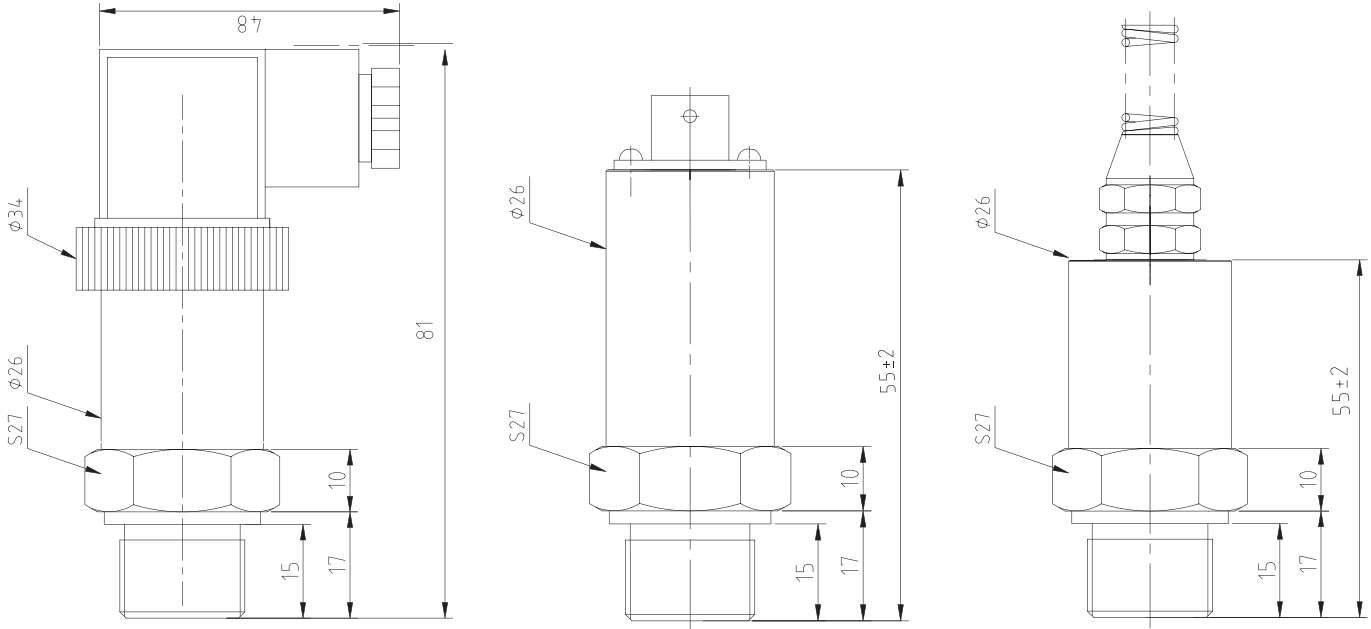

### HOW TO ORDER

#### ⚙️ Basic Model:

1	0.5 to 4.5V (ratiometric)	2	4 - 20mA	3	1 to 5V	LR12	2
4	0 to 10V	5	0 to 5V	6	0 to 100mV		

#### ⚙️ Process Connection:

1	1/4" BSP (M)	2	1/2" BSP (M)	3	7/16" UNF (M)		1
4	1/4" NPT (M)	5	1/2" NPT (M)	7	1.5" Sanitary		

#### ⚙️ Electrical Connection:

1	2ft Cable	2	2ft Cable with IP68 Gland	5	M12		6
4	Packard Metripak Connector	5	Bendix	6	Hirschman DIN 43650		

#### ⚙️ Pressure Range:

Please Refer to the range table

#### ⚙️ Units:

MB	Bar						MB
P	Psi						

#### ⚙️ Pressure Type:

A	Absolute Pressure						G
G	Gauge Pressure						
C	Compound Pressure						

Ordering Example:  
LR1221-6-010MBG